

East Sussex County Council Planning Committee 16 December 2020

Page 1

East Sussex
County Council

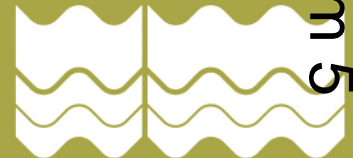

WD/843/CM

Reconfiguration of site layout including:- extension to yard; installation of vertical silo; installation of weighbridge; erection of storage building; operation of concrete crusher; new lighting scheme; new drainage infrastructure; full conversion of Brownings to office and HMO accommodation

Woodside Depot, Hailsham Road, Polegate BN27 3PG

WD/843/CM
Woodside Depot, Hailsham Road, Polegate, BN27 3PG

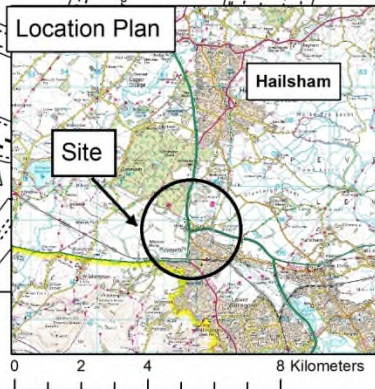
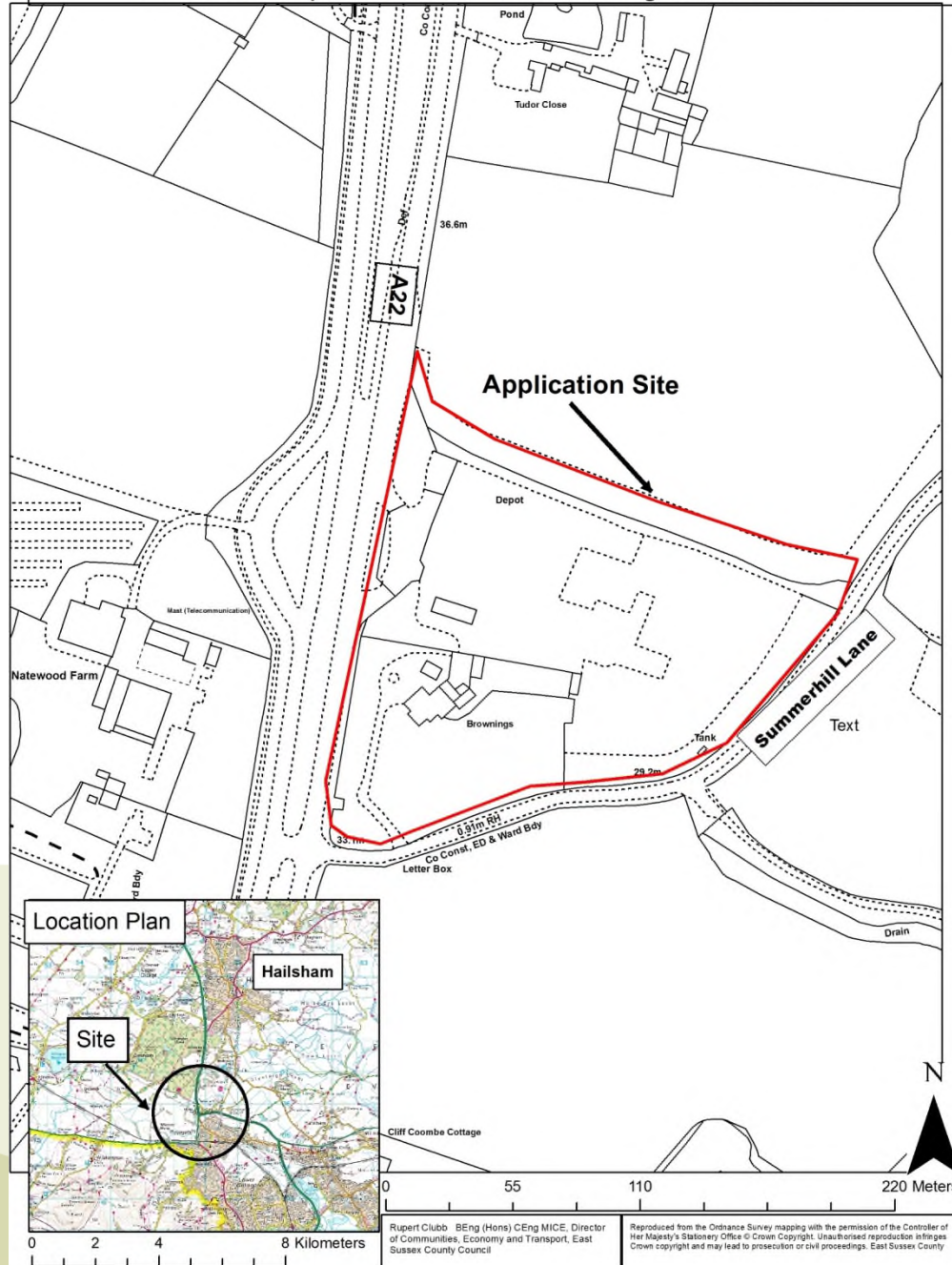

Rupert Clubb BEng (Hons) CEng MICE, Director of Communities, Economy and Transport, East Sussex County Council

Reproduced from the Ordnance Survey mapping with the permission of the Controller of Her Majesty's Stationery Office © Crown Copyright. Unauthorised reproduction in breach of Crown copyright may lead to prosecution or civil proceedings. East Sussex County Council



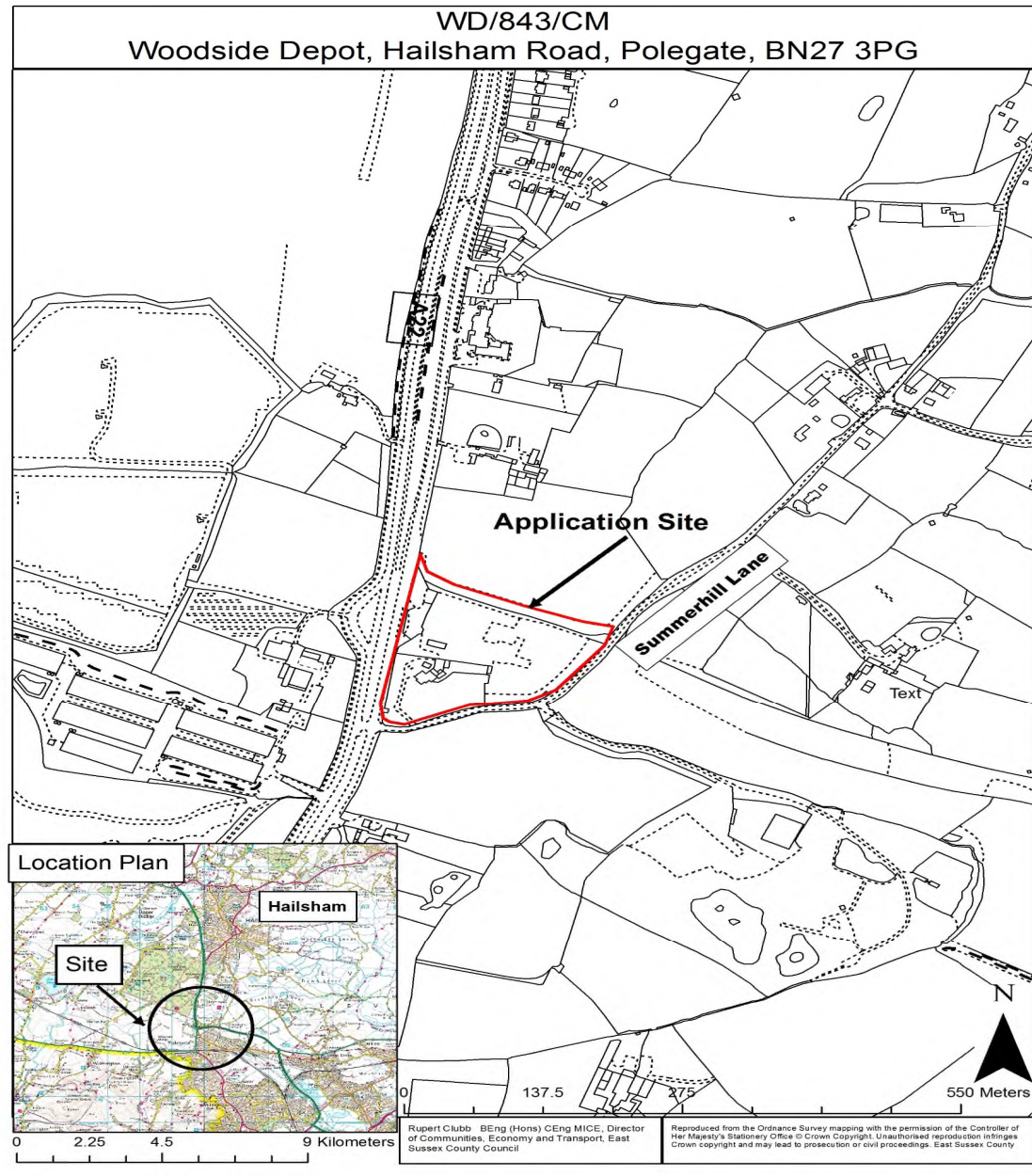

WEIGH HOPPER ARRANGEMENTS AND SUPPORT STRUCTURES

Page 7

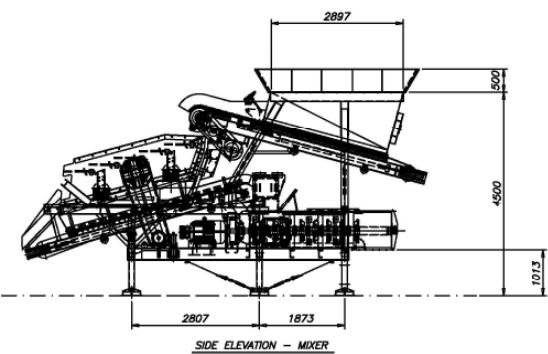
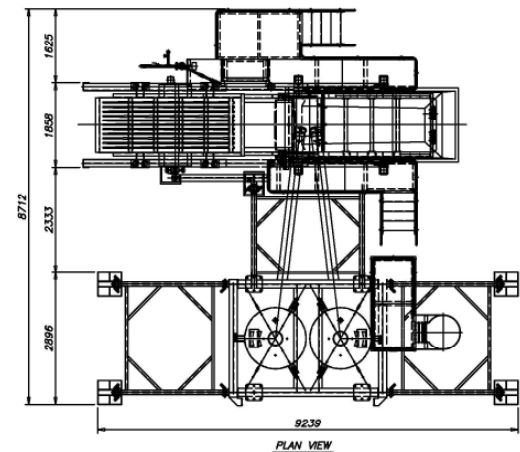
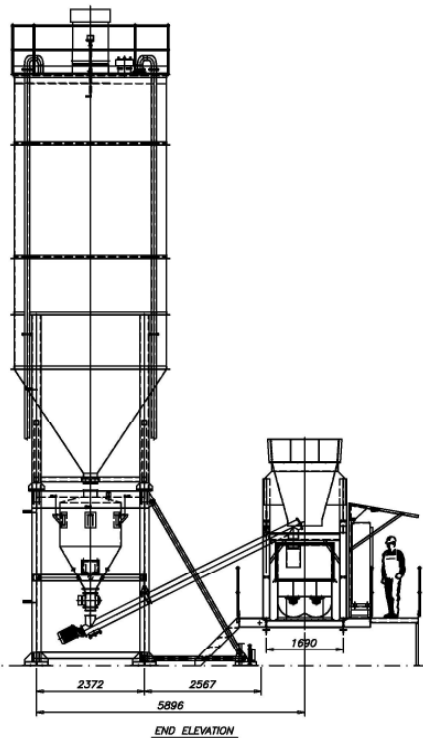
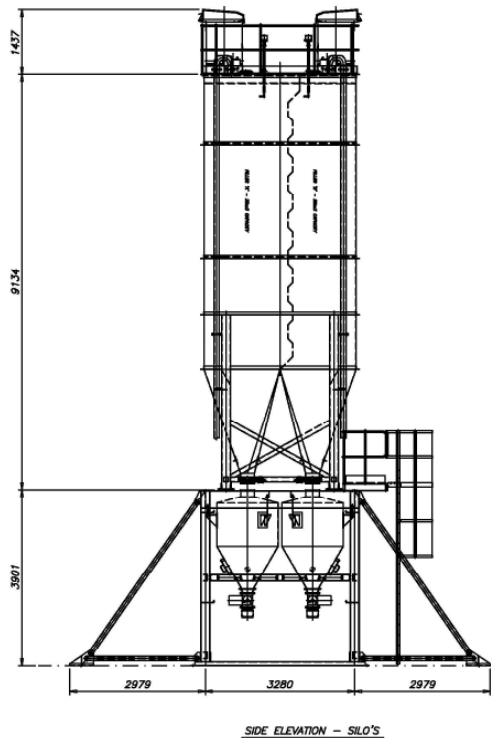

THIS DRAWING OWNED BY
B.G. EUROPA (UK) LTD
MIDNHAMPTON, NENHAMPT, ENGLAND
IS CONDITIONALLY LOANED TO

WHO BY RECEIVING IT HAS AGREED NOT TO REPRODUCE OR
COPY IT, IN WHOLE OR PART, OR TO FURNISH INFORMATION
FROM IT TO OTHERS, OR TO MAKE ANY USE OF IT THAT
IT IS OR MAY BE PREJUDICIAL TO B.G. EUROPA (UK) LTD
AND TO RETURN IT UPON REQUEST.

**ARRANGEMENT OF
809 WEIGH HOPPER &
SUPPORT STRUCTURE**

DRAWN BY: G. A. NICK DATE: 04/06/09
CUSTOMER: SCALE: 1:75 @ A1
ORDER NO. DWG NO. PL 1429
SHEET 1 OF 3

ISSUE: DATE:

ISSUE	DATE
1	
2	
3	
4	
5	
6	
7	
8	
9	
10	
11	
12	
13	
14	

ALL SLOTS _____ UNLESS NOTED
ALL HOLES _____ UNLESS NOTED

WORKING TOLERANCES UNLESS NOTED

STRUCTURAL DIM. DIMENSIONS	METRIC SYSTEM	INCH SYSTEM
	+ 0.0 - 1.0mm	+ 0.0 - 1/16"

BETWEEN FINISHED SURFACES

Page 10



Page 11



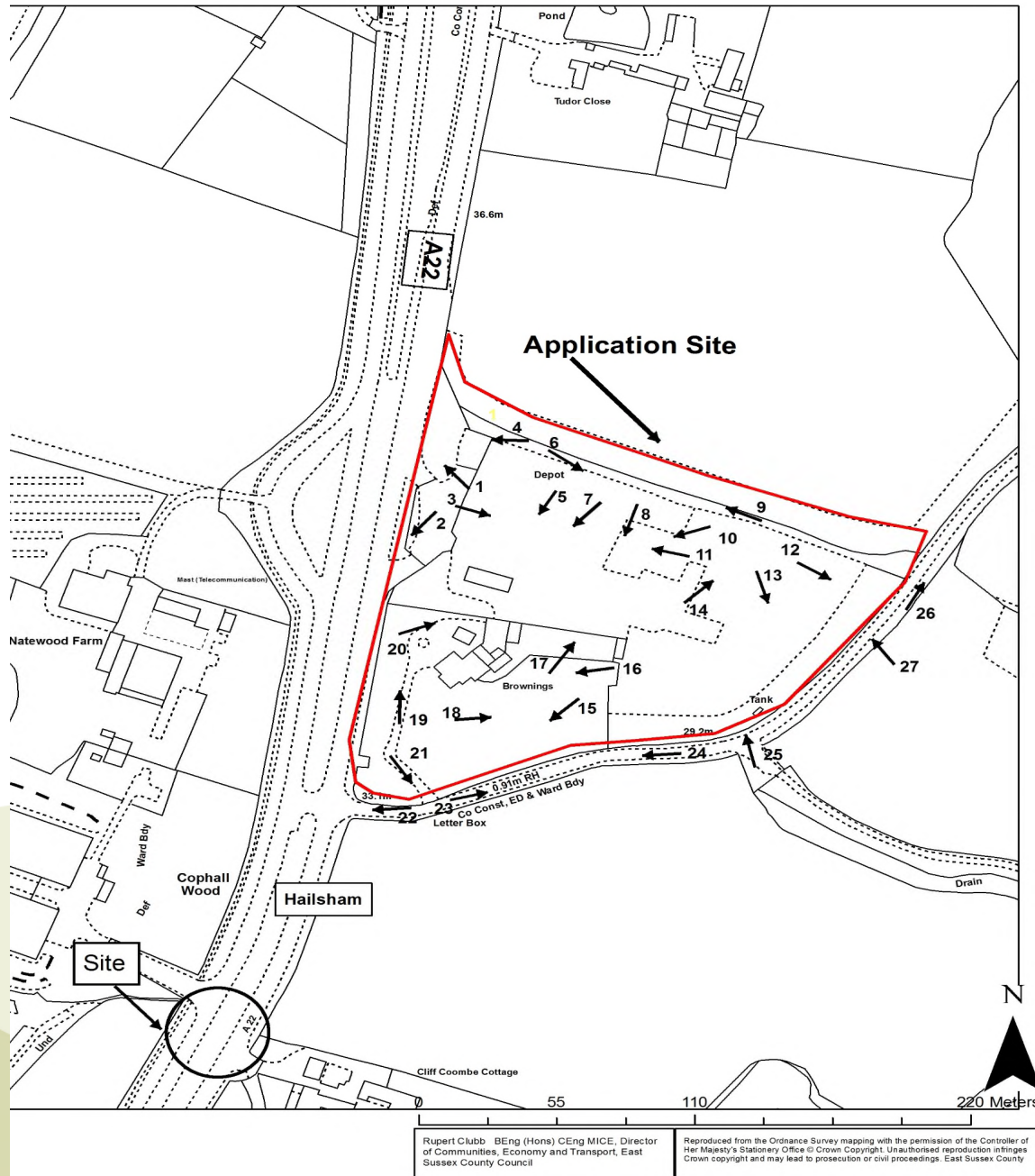

1. Access into depot from A22

Page 13



2. Egress from depot onto A22

Page 14



3. View east / north east across depot



4. North-western side of depot



5. Western part of depot – parking and storage



6. Northern side of depot looking east



7. View south-west across central-western side of depot



8. South-central side of depot



9. Central-northern part of depot



10. Horizontal silo – southern part of depot



11. Central part of depot looking west



12. Materials stockpiles at eastern part of site



13. Material stockpiles at south-eastern part of site



14. View north-east across eastern part of depot



15. Garden of Brownings looking south-west



16. Garden of Brownings looking west

Page 28



17. Building used as laboratory from Brownings' garden with stockpiles to the rear



18. Garden of Brownings looking east



19. Driveway of Brownings looking north



20. Front of Brownings



21. Access from Brownings onto Summerhill Lane



22. Looking west from junction of Brownings' access with Summerhill Lane



23. Looking east from junction of Brownings' access with Summerhill Lane



24. Looking west along Summerhill Lane with site behind hedgerow to the right

Page 36



25. South-eastern part of site from Summerhill Lane showing damage to trees on boundary



26. View north-east along Summerhill Lane with site on left



27. View of silo looking north-west from Summerhill Lane



WD/843/CM

Reconfiguration of site layout including: extension to yard; installation of vertical silo; installation of weighbridge; erection of storage building; operation of concrete crusher; new lighting scheme; new drainage infrastructure; full conversion of Brownings to office and HMO accommodation

Woodside Depot, Hailsham Road, Polegate BN27 3PG