

Appendix 2: Map showing the letter drop extent, Consultation Plan, Consultation Letter, and Consultation Questionnaire.

Map of Letter Drop Extent:

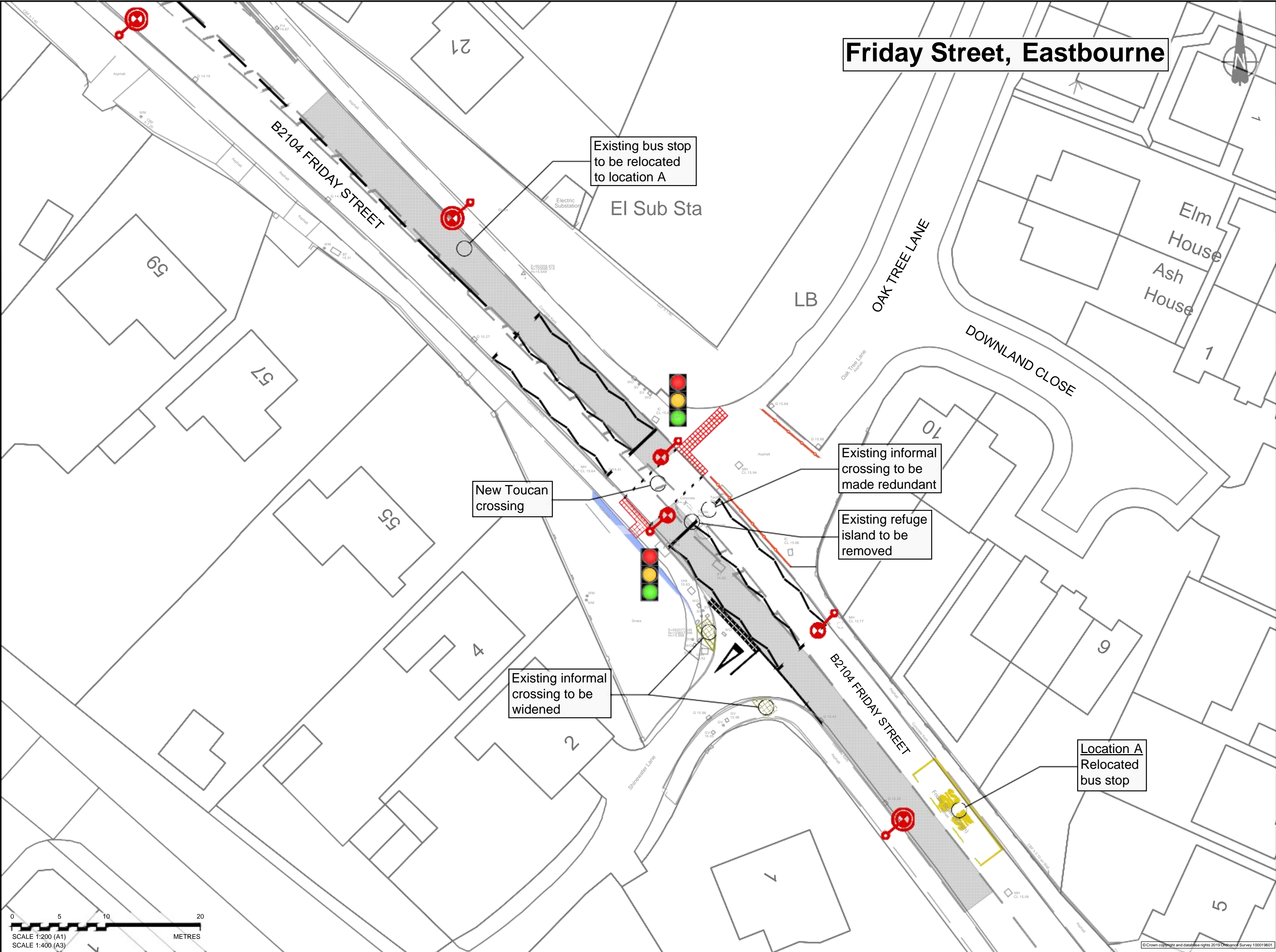



- LEGEND**
- Existing Road Markings
 - New Road Markings
 - Anti-skid surfacing
 - Widened footway
 - Tactile paving
 - Guardrailing (Fence)
 - New or upgraded street lamp column
 - Traffic light control

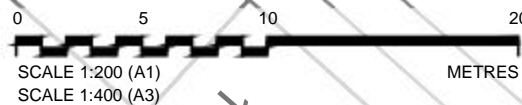

P01 S2 01/02/2019 First Issue IM CLS CE

Rev	Status	Rev. Date	Purpose of revision	Drawn	Chk'd	Appr'd
-----	--------	-----------	---------------------	-------	-------	--------



EAST SUSSEX HIGHWAYS
RINGMER DEPOT, THE BROYLE
RINGMER, EAST SUSSEX, BN8 5NP
Tel. 0345 60 80 193 www.eastsussexhighways.com

Project
SCH-033 FRIDAY STREET PED. IMPROVEMENTS
Drawing title
Consultation plan

Status	S2	Revision	P01
Scale	1:200	Date	01/02/2019
Drawn By	T Moreno		
Checked By	C. Lopez-Smith		
Approved By	C. Emeahuruwa	Originator	
Project No.	3520000	ESH	Original Size
Drawing number	EGN-SCH0033-DR-CH-0001	Volume	Design Alt. Type Gate Number
			A1

February 2019

RE: Friday Street - Proposed Pedestrian and Cycle Crossing Facility

Dear Sir/Madam,

East Sussex Highways has identified the existing informal crossing facility along the B2104 Friday Street Eastbourne, near the junction with Oak Tree Lane, as a site for improved pedestrian and cyclist crossing facilities.

As you may already be aware the crossing is used by local residents and pupils needing to cross the B2104 at this location to access the local primary schools, secondary schools and nearby amenities in the area. Currently there is no dedicated crossing facility to assist them to cross this busy road.

The aim of this scheme will be to introduce a signalised pedestrian and cyclist-controlled crossing facility known as a Toucan Crossing. We will also be improving the street lighting at the crossing and on each approach, which will increase the visibility of drivers, cyclists and pedestrians.

Please also find enclosed a plan showing the details of the scheme which include:

- Installation of new traffic signals columns.
- Installation of new lighting columns on both approaches and at the crossing to ensure lighting levels meet current standards.
- Improved footway access to the kerbs and footway.
- Anti-skid surfacing to help reduce stopping distances on each approach.
- The relocation of the existing bus stop to improve visibility at the crossing point for pedestrians and drivers.
- Zig-zag road markings on each approach. These markings will prohibit parking to ensure good visibility between pedestrians, cyclists and drivers.

Construction of the new improved crossing facility is planned to take place during late summer 2019. Duration of the works is estimated to take about 5-6 weeks. A further letter will be distributed to provide exact dates for construction when such a timescale has been confirmed.

We are writing to residents near the proposed crossing to see if they have any comments regarding the scheme. Please see attached form and free post envelope. You can also get in touch with us by phone (see above number) and email customer@eastsussexhighways.com.

Information on the scheme is also available on our website:
www.eastsussexhighways.com/consultations.

Please feel free to submit your comments by Friday 8th March 2019.

We thank you for your time and kind understanding.

Best Regards

East Sussex Highways

Freepost East Sussex Highways

Friday Street – Pedestrian and Cycle Crossing Facility

Your views about our proposals

We would like your views on the proposals.

An online version of this questionnaire is available on our website along with plans showing the proposals:

www.eastsussexhighways.com/consultations

Please return your completed questionnaire by **Friday 8 March 2019** using the 'Freepost East Sussex Highways' address.

All responses received will be treated in the strictest confidence; the Council will use the responses from this questionnaire for research purposes only.

We are asking these questions as we want to make sure that we have a representative view of the proposals from residents, businesses and stakeholder groups.

SECTION 1 – Your Status

Q1. Are You... ☐ An individual ☐ A business ☐ Other

If business or other please provide details:

Q2. Please provide your postcode. (It will not be used to identify you)

SECTION 2 – About the proposals

Q3. To what extent do you support the proposed pedestrian and cycle crossing facility on Friday Street?

☐ Support

☐ Oppose

☐ No opinion

Q4. If you do not support the proposals, please tell us why.

Q5. Are there any comments that you would like to make about your response or about how the proposals may affect you?