

Polegate High Street Improvements Public Consultation

Prepared for

East Sussex County Council

December 2021



Ringer Offices
The Broyle
Ringmer
East Sussex
BN8 9NP

Contents

Section	Page
Document Issue	v
Acronyms and Abbreviations	vi
Executive Summary.....	vii
1. Introduction	9
2. Informal Consultation	10
3. Formal Consultation.....	11
4. Conclusions	13
Appendix A – Formal Consultation	14
List of Consultees	14
Appendix B – Consultation Documentation	18
Appendix C – Consultation Response Summary	22
Appendix D – ESH Citizen Space – Response Summary	25
Appendix E – Email Response Summary	28

.

Document Issue

Revision History

Issue	Author	Date	Description
1	Ian Tingley	01/12/21	Draft issue issued for comment.
2	Ian Tingley	31/01/22	Revision P01

Technical Check

Role	Name	Signature	Date
Senior Design Engineer	C Kwok	C Kwok	31/01/22

Approval

Role	Name	Signature	Date
Design Team Manager	D Johns	<i>D Johns</i>	31/01/22

Acronyms and Abbreviations

ESCC	East Sussex County Council
ESH	East Sussex Highways

Executive Summary

East Sussex Highways (ESH), in partnership with East Sussex County Council (ESCC) have developed proposals to introduce improvements along High Street, Polegate. The main objective of the scheme is to make the High Street safer for all users to access as well as making it more attractive to visit.

To achieve the objectives of the scheme the following measures are proposed:-

- Reducing the existing 30mph speed limit to 20mph along the length of High Street;
- Improvements to the bus stops outside the Polegate Railway Station and the Downlands Medical Centre to provide easier bus access and to provide high access kerbing;
- Provision of dropped kerbing and tactile paving at all pedestrian crossing points; and
- Repairs to the existing footway surfaces where required.

These measures will improve the experience for pedestrians, particularly those that require dropped kerbs such as those with mobility or sight impairments, pedestrians with prams / buggies / trolleys etc) as well as bus drivers and public transport users.

A public consultation was held on the proposals commencing Monday 1 November 2021. All responses were to be returned by the end of Friday 26 November 2021.

A public exhibition was not held for this scheme but, instead, approximately 6000 letters were delivered around Polegate to ensure that everyone within the locale was given the opportunity to provide comment. These were in addition to the 30 statutory consultees who were emailed the consultation material direct. All consultees were invited to provide comment via the ESH Citizen Space portal or by emailing the ESH Contact Centre.

79 responses were received via the Citizen Space and 25 responses by email – a total of 104 responses. The return rate equates to approximately 1.7% of the potential, total, number of responses.

59 responses (56.7%) were in support of the proposal to reduce the speed limit to 20mph. 33

responses (31.7%) were against the proposals.

12 responses (11.6%) provided comment but did not, specifically, express support or objection to the proposals.

Only 6 responses were received from the 30 consultees included on the Statutory Consultee list. From

the comments received the following two issues emerged as the key concerns:-

- Action needs to be taken to resolve problems caused by inappropriate parking including the need for parking enforcement.
- Speeding was not seen to be a problem along High Street as there are usually lengthy queues and delays caused by the level crossing.

Following completion of the public consultation ESCC now need to decide whether or not to progress with the scheme in its current form.

In light of the comments received it is recommended that a review of the proposals is carried out to determine whether or not there is scope to incorporate any additional measures into the scheme.

To this end it is recommended that a meeting is held between ESCC and ESH at the earliest opportunity to discuss the next steps for the scheme.

1. Introduction

- 1.1. East Sussex Highways, through their design office in London, has worked in partnership with East Sussex County Council to promote a scheme to introduce a 20mph speed limit along the whole of High Street, Polegate.
- 1.2. The proposed speed reduction extends between the B2247 Station Road at the northern end of High Street and the A2270, Eastbourne Road, at the southern end. The proposed speed limit will also extend into each of the side roads by approximately 10m.
- 1.3. The proposed measures also aim to improve the bus stops adjacent to the Railway Station and the Downlands Medical Centre by re-aligning the entry kerbing to make it easier for buses to access the stops and providing high access kerbing to enable pedestrians to alight buses more easily.
- 1.4. An informal consultation with the statutory consultees was held in 2020. Comments arising from this informal exercise were incorporated into the scheme prior to commencing the formal consultation.
- 1.5. The formal consultation on the proposals was held between 1 November 2021 and the end of 26 November 2021.
- 1.6. This report is prepared to record the processes carried out and to record and comment on the results of the formal consultation.
- 1.7. All comments received will be assessed and used to shape the final layout of the scheme.

2. Informal Consultation

- 2.1. An informal consultation was carried out by ESH London office in November 2020.
- 2.2. From this exercise comments were received from 2 consultees – Network Rail and Sussex Police, each of whom raised concern about different aspects of the design.
- 2.3. Network Rail were concerned about visibility to the level crossing being obscured by southbound buses waiting at the adjacent bus stop. The proposed layout required buses to overhang the live carriageway.
- 2.4. Sussex Police raised concern about existing zig-zag road markings that extended into the circulatory carriageway at the mini roundabout at the northern end of High Street.
- 2.5. In August 2021, following completion of the informal consultation process, the project was handed over to ESH Ringmer office to progress.
- 2.6. The two items raised from the informal consultation were subsequently addressed and the solutions accepted, respectively, by both Sussex Police and Network Rail.
- 2.7. Approval was subsequently received from ESCC to progress the scheme to the formal consultation stage.

3. Formal Consultation

- 3.1. The formal consultation commenced on Monday 1 November 2021 and concluded at the end of Friday 26 November 2021.
- 3.2. Copies of the consultation letter and plan were emailed to the Councillors on Friday 29 October to give them advance notice of the forthcoming consultation.
- 3.3. 30 Statutory Consultees were sent the consultation material and invited to comment on the proposals. A full list of the Statutory Consultees is included in Appendix A.
- 3.4. An exhibition was not required for this scheme but, instead, approximately 6000 letters were delivered to properties within Polegate to give all residents the opportunity to provide comment on the proposals. The letters were delivered between Monday 1 November and Wednesday 3 November.
- 3.5. Copies of the letter and accompanying drawings were also posted on ESH Internet – Citizen Space – where residents were directed to provide comment.
- 3.6. A copy of the letter and accompanying plans are included in Appendix B.
- 3.7. At the close of the consultation period 79 responses had been provided on Citizen Space and an additional 25 responses had been emailed to the Contact Centre.
- 3.8. A total of 104 responses were received during the consultation period. This equates to a return rate of approximately 1.7%.
- 3.9. Of the responses received:-
- 59 responses (56.7%) were in support of the proposal to reduce the speed limit to 20mph.
 - 33 responses (31.7%) were against the proposals.
 - 12 responses (11.6%) provided comment but did not, specifically, express support or objection to the proposals.
 - Only 6 responses were received from the 30 consultees included on the Statutory Consultee list.
- 3.10. A summary of the responses received is included in Appendix C.
- 3.11. From the comments received the following 2 key items emerged as the main concern of the residents:-
- 24 of the respondents commented that there is no, specific, speeding problem along High Street as vehicles are regularly delayed by the level crossing. The proposed speed reduction did not appear to be necessary.

- **23 comments were received concerning inconsiderate parking along High Street and the need for the existing parking restrictions to be policed. Many the of comments referred to problems caused by vehicles being parked on footways.**

3.14. The next highest ranking comments were as follows:-

- **8 respondents suggested that the 20mph limit should be extended to encompass a wider area of Polegate, including the side roads.**
- **8 respondents suggested that vehicle speeds needed better policing.**
- **6 respondents commented that ANPR and / or speed cameras should be introduced to the High Street.**
- **5 respondents believed that the scheme offered no significant benefits and considered it to be a waste of money.**
- **4 respondents asked that consideration be given to the introduction of additional pedestrian crossing facilities south of the level crossing.**

3.15. A summary of the comments received through ESH Citizen Space and by email are included in Appendices D and E respectively.

3.16. 3 comments requested that consideration be given to the introduction of informal Zebra crossings as these are currently under trial in Manchester. In response to this specific point if the trials are successful these features could be considered but only once the full legislation, guidance and regulation is in place. Until such time these features cannot be introduced onto the Public Highway.

4. Conclusions

- 4.1. The level of response received was considered low, with 104 responses being received from a distribution of approximately 6000 letters. This equated to a return rate of 1.7%.
- 4.2. Of these 104 responses, however, 57% expressed support for the measures, which does give a mandate to progress the scheme. 32% of the responses were from residents who did not support the proposals.
- 4.3. The response from the Statutory Consultees was low, with only 6 of the 30 individuals and groups providing comment.
- 4.4. 24 of the respondents felt that there was no need to introduce the 20mph limit as they did not consider speeding to be a problem through the High Street. Conversely, however, 8 residents asked that the 20mph speed limit was introduced over a wider area as they had experienced excessive speed along their residential roads.
- 4.5. 23 respondents suggested that improved enforcement was needed to remove bad and illegal parking through the town, this being one of the key areas where pedestrian safety was cited as being affected.
- 4.6. From analysis of the consultation results there would appear to be a majority support for the scheme.
- 4.7. If the decision is taken to progress the scheme through to construction it is recommended that consideration be given to implementing some of the suggestions made, including the introduction of additional pedestrian crossing facilities along High Street. 4 of the residents requested that consideration be given to the provision of pedestrian crossing facilities south of the level crossing. If achievable, this would go some way to achieving the objective of the scheme to make the High Street safer for all users to access as well as making it more attractive to visit.

Appendix A – Formal Consultation

List of Consultees

The following table lists the departments, groups, private and public bodies included in the formal consultation:-

ESCC Departments	
Road Safety Team	Traffic.Safety@eastsussex.gov.uk
Passenger Transport group	publictransport.pts@eastsussex.gov.uk
Parking Team	Parking.escc@eastsussex.gov.uk
Transport Development Control	DevelopmentControl.Transport@eastsussex.gov.uk
Asset Management	Contracts.ManagementGroup@eastsussex.gov.uk
County Ecologist	kate.cole@eastsussex.gov.uk
County Archaeologist	County.Archaeology@eastsussex.gov.uk
Senior Asset Engineer (Soft Estate)	james.newmarch@eastsussex.gov.uk
Landscape Group	virginia.pullan@eastsussex.gov.uk
Planning Team	development.control@eastsussex.gov.uk
County Councillor (Current as at 13/09/21)	Postcode BN26 5EP (Polegate South & Willingdon Watermill ward) cllr.daniel.shing@eastsussex.gov.uk
District and Boroughs	
District and Borough Councils	Use link to website: https://maps.wealden.gov.uk/WebMap/
District and Borough Councillors	Postcode BN26 5EP cllr.oilin.shing@wealden.gov.uk Councillors in adjacent wards:- cllr.angela.snell@wealden.gov.uk (Polegate Central ward) cllr.raymond.shing@wealden.gov.uk (Upper Willingdon ward) cllr.stephen.shing@wealden.gov.uk (Lower Willingdon ward) cllr.alastair.douglas@wealden.gov.uk (Stone Cross ward)
Member of Parliament	No requirement to contact.

District/Borough Conservation Officer	Jo Tucker – Conservation Officer Jo.Tucker@wealden.gov.uk
Towns and Parish Councils	
Town & Parish councils	admin@polegatetowncouncil.gov.uk
Other Authorities	
Highways England	N/A
Environment Agency	N/A
South Downs National Park	N/A
East Sussex Fire and Rescue	Borough Commander for Wealden & Eastbourne: Pup.upton@esfrs.org
Police	Chris Cannon: Christopher.Cannon@surrey.pnn.police.uk
South East Coast Ambulance Service	Eastbourne, Wealden (Inc. Newhaven), Hastings, Rother eastsussexmanagers@secamb.nhs.uk
Network Rail	Donald Gilmour Donald.Gilmour2@networkrail.co.uk
Road User Groups	
Bus companies	Stagecoach dimitri.bridgland@stagecoachbus.com
Road Haulage Association	L.white@rha.uk.net
Freight Transport Association	South East (Kent, Sussex, Surrey) – trafficorderssoutheast@logistics.org.uk
Access and Cycle Groups	
Disability Groups	Debbie Peters - Equalities Officer Debbie.Peters@wealden.gov.uk
Cycle groups	Cycling UK

	cycling@cyclinuk.org
Statutory Undertakers	
Statutory undertakers	No requirement to contact
Other	
Schools	None
Local businesses/shops	F1 Autocentre ian.keeley@F1Autocentres.com -
GP Surgery	GP surgery – medical centre louise.goatcher@nhs.net
Clearchannel	Clear Channel Samantha.Williams@ClearChannel.co.uk
Residents groups/associations	None
Residents	None

Appendix B – Consultation Documentation

- 1) Consultation Letter
- 2) Small-Scale Plan (back to back with letter)
- 3) Full scale Plan (available to view online during consultation)

INFORMATION ON PROPOSALS FOR POLEGATE HIGH STREET IMPROVEMENT WORKS AND SPEED LIMIT REDUCTION

1 November 2021

Dear Resident,

Polegate High Street 20mph Speed Limit and Pedestrian Improvements

East Sussex Highways, in partnership with East Sussex County Council, is proposing to improve pedestrian and bus stop facilities and introduce a 20mph speed limit along Polegate High Street. This will be between the A2270 Junction (Wannock Rd, Eastbourne Rd and A2270) and the B2247 (Station Road/Hailsham Road) junction in Polegate.

I am writing to provide you with information about the proposal and let you know a public consultation exercise will take place from Monday 1 November to Friday 26 November 2021.

The main objective of the scheme is to make the High Street safer for all users to access, as well as more attractive to visit. In addition to the 20mph speed limit, to achieve the scheme's objectives there will be other improvement work: tactile paving and dropped kerbs will be introduced at existing junctions along Polegate High Street that do not currently have them; localised areas of footway will be resurfaced; and improvements will be made to the bus stops outside the Polegate Rail Station and in front of the Downland Medical Centre. A simplified plan showing the proposed layout has been included overleaf. A larger print copy of the proposed layout can be provided upon request.

These changes will improve the experience for pedestrians, particularly those that require dropped kerbs (such as those with mobility or sight impairments, pedestrians with prams/buggies/trolleys etc.) as well as bus drivers and public transport users.

Commenting on the proposal

We would be pleased to receive any comments or concerns you may have regarding the proposal by no later than the end of Friday 26 November 2021 via the Citizen Space portal:

<https://consultation.eastsussex.gov.uk/economy-transport-environment/polegate-high-street>.

You can also write directly to me at FREEPOST, East Sussex Highways or by email: customer@eastsussexhighways.com. If you don't have access to the website please contact us and we will send you a copy of the consultation.

The comments we receive will help shape the final proposals and the decision on whether to proceed to construction. Any improvements would be funded using development contributions secured from development in Polegate towards local transport schemes.

Yours sincerely,

I M Tingley

Ian Tingley | Project Manager
Infrastructure & Transportation | East Sussex Highways

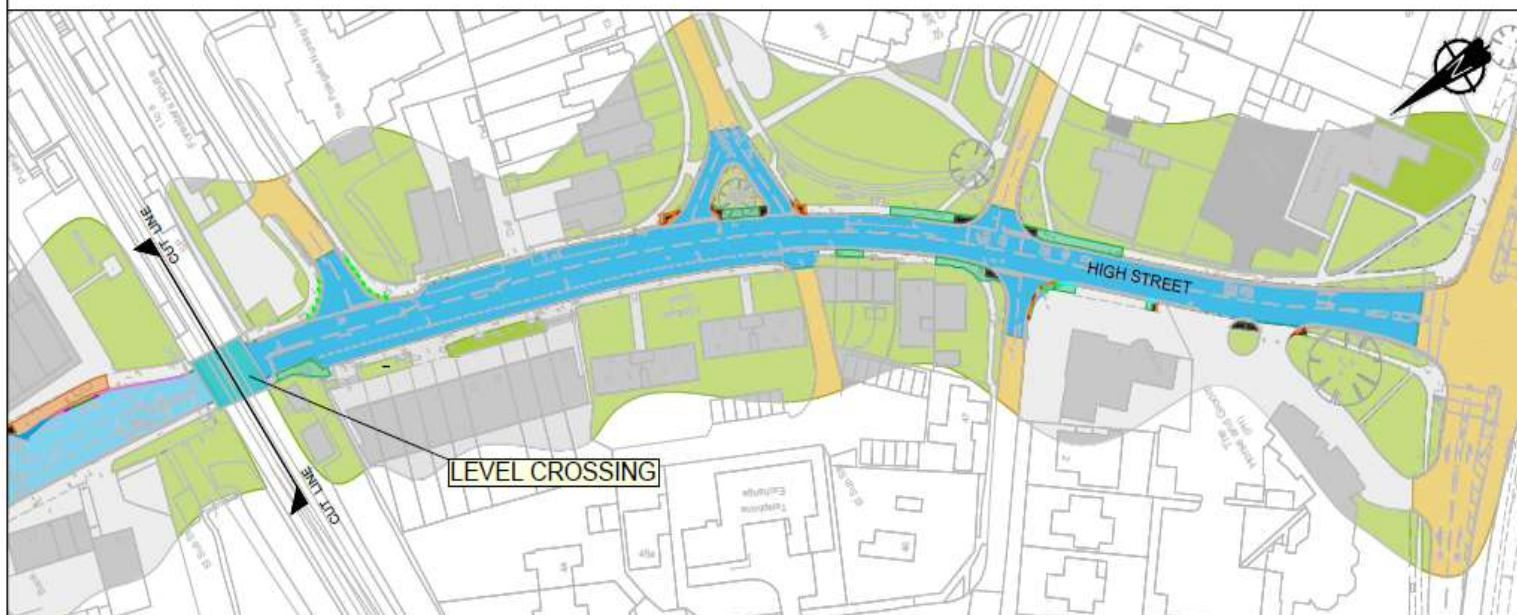
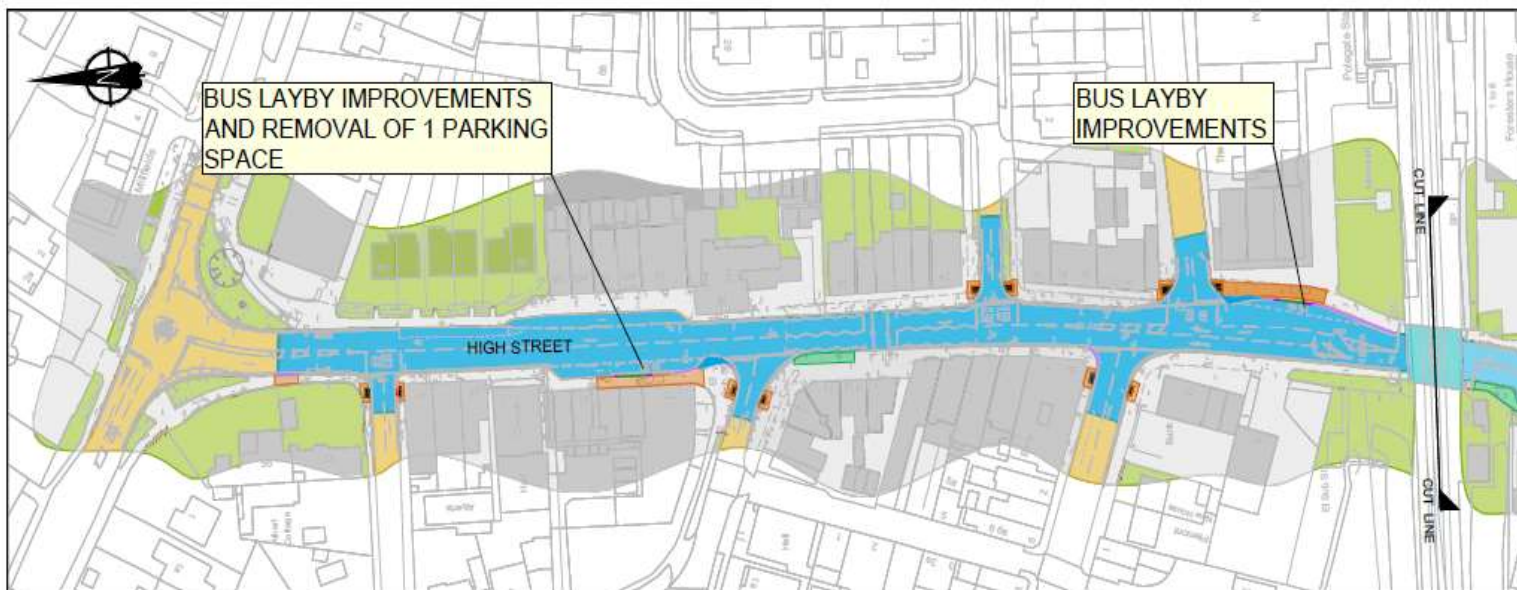

NOTES

1. Background based on Ordnance Survey mapping supplemented with topographical survey.
2. DO NOT scale from this drawing.
3. Proposed measures to include:-
 - localised footway surface repairs / improvements.
 - improved dropped kerbing and provision of tactile paving at all crossing points.
 - replacement of pedestrian guardrailling with bollards.
4. A full version of this drawing can be viewed online at:-

<https://consultation.eastsussex.gov.uk/economy-transport-environment/polegate-high-street>

REV	02	01/10/2021	Minor Reference inserted from key	11	OK	11
REV	02	01/10/2021	We've had amendments to notes	11	OK	11
REV	02	01/10/2021	We've updated to notes	11	OK	11
REV	02	01/10/2021	Final Issue	11	OK	11
Rev	Status	Date	Purpose of revision	Drawn	Checked	By

LEGEND - PROPOSED MEASURES

- Existing speed limit to remain.
- Existing 30mph speed limit reduced to 20mph.

Scale	SD	POA
Drawn by	11	04
Checked by	11	04
Approved by	11	04
Project No	302000	CHD
Drawing number	Volume 1	Design 11
	01/10/2021	01/10/2021

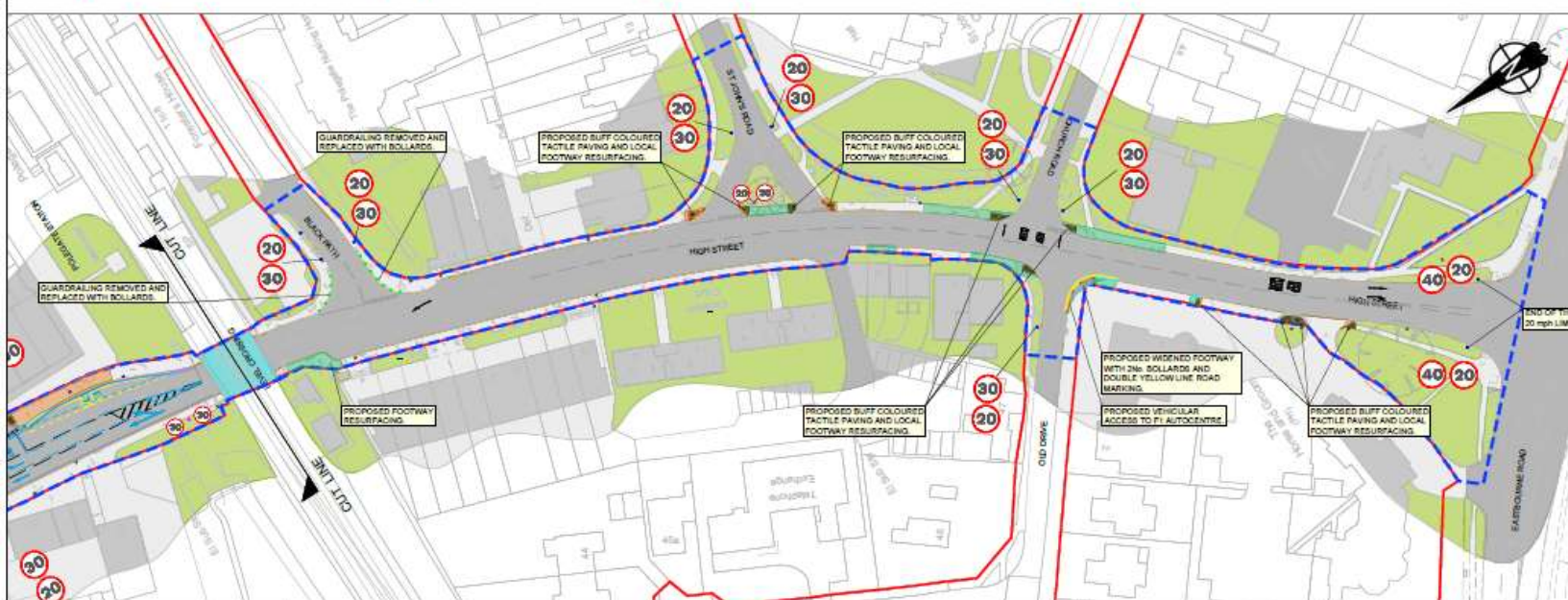
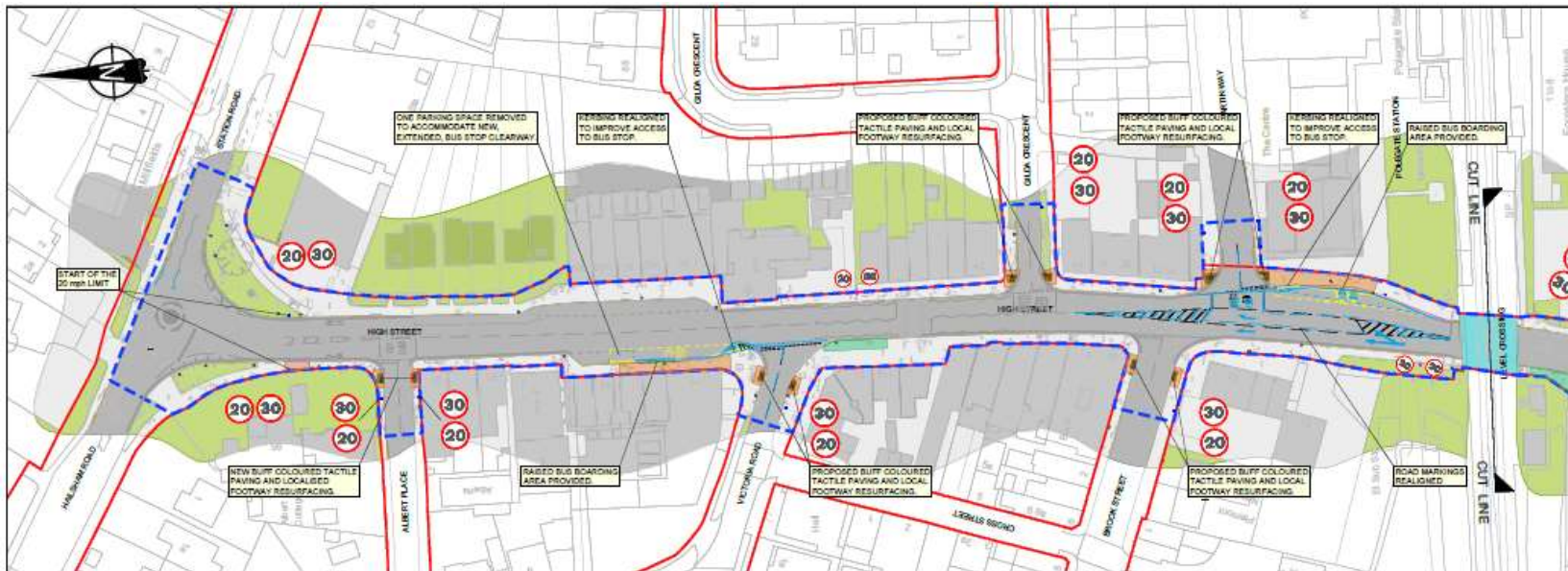

- NOTES**
1. Background based on Ordnance Survey mapping supplemented with topographical survey.
 2. DO NOT scale from this drawing.
 3. This drawing shall be printed in colour.
 4. All existing road markings other than those specifically identified on this drawing are to be refreshed.

101	01	10/08/2021	Updated to reflect current layout	10	01	01
101	01	20/08/2021	Final	01	01	01
Rev	Status	Rev Date	Purpose of revision	Drawn	Checked	Approved

LEGEND	
	Highway Boundary
	Scheme Extents
	Proposed full height kerb
	Proposed dropped kerb
	Proposed kerbside kerb
	Proposed white road markings
	Proposed yellow road markings
	Existing road markings to be removed
	Proposed carriageway construction
	Proposed buff blue tactile paving
	Proposed footway construction
	Existing footway re-surfaced
	Proposed traffic sign
	Traffic sign to remain
	Proposed bollard
	New traffic sign - 600mm diameter / 300mm repeater

East Sussex Highways
A partnership between

EAST SUSSEX HIGHWAYS
RINGER DEPOT, THE BROYLE
RINGER, EAST SUSSEX, BN9 5NP
Tel: 01424 60 60 183 www.eastsussexhighways.com

Project	Polegate High Street
Drawing title	General Arrangement Consultation Plan

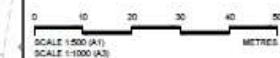

© Crown copyright and database rights 2021 Ordnance Survey 100019811

Sheet	02	Version	P02
Scale	1:500	Date	2021/04/13
Drawn by	I. Tingley		
Checked by	C. Wood		
Approved by	I. Tingley		
Project No.	3020000	Project	CH2
Original title			
Sheet number		Volume 1	Drawn to: 1 Type 1 Rev 1 Number
			HGN-SCH122B-OR-2H-0002

[illegible]

Consider the 2 mobility hubs proposed in the BSIP bid.	3	1	1	1
Need informal crossings as per Manchester trial.	3	1	1	1
Pedestrian guardrailing should be retained. (1 x partially sighted resident uses them as a guide)	3	1	1	1
More seating and trees needed.	3	1	1	1
Needs a pedestrian crossing near to the school.	3	1	1	1
Make St John's junction one-way in / out.	2	1	1	
Disabled space needs to be provided in the layby fronting and opposite the medical centre.	2	1	1	
Footbridge needed over railway	2	1	1	
Ped crossing needed on west side of roundabout on B2247.	2	1	1	
Additional traffic calming measures should be introduced.	2	1	1	
Better ped crossing facilities needed north of level crossing - especially when traffic queues because of the crossing.	2	1	1	
Major issue for pedestrians is drivers overtaking traffic queuing at the crossing	2	1	1	
Box junction marking is needed at High Street / Roy Martin Way	1	1		
Box junction marking needed at High Street / St John's Road	1	1		

Northbound bus stop needs to accommodate 2 buses - it's a waiting stop.	1	1
Additional bollards needed to stop parking on footways.	1	1
High Street should be made on-way.	1	1
Improved signage from Station to bus stops would be useful.	1	1
Footway by Dinkum PH too narrow.	1	1
Better signing asking drivers to turn off engines at crossing.	1	1
Remove all parking from the bus laybys.	1	1
Alter traffic flow directions on Church Road, St John's Road and Albert place.	1	1

Appendix D – ESH Citizen Space – Response Summary



Polegate High Street: Summary report

This report was created on Monday 29 November 2021 at 10:36 and includes 79 responses.

The activity ran from 01/11/2021 to 26/11/2021.

Contents

Question 1: Do you support the introduction of a 20mph speed limit along Polegate High Street?	1
Support 20mph	1
Do you have any comments further to your answer?	1
Question 2: Do you support proposals to upgrade bus stop facilities on Polegate High Street?	1
Bus stop proposals	1
Do you have any comments further to your answer?	2
Question 3: Do you support the proposals for the pedestrian areas on Polegate High Street?	2
Do you support pedestrian areas	2
Do you have any comments further to your answer?	2

Question 1: Do you support the introduction of a 20mph speed limit along Polegate High Street?

Support 20mph

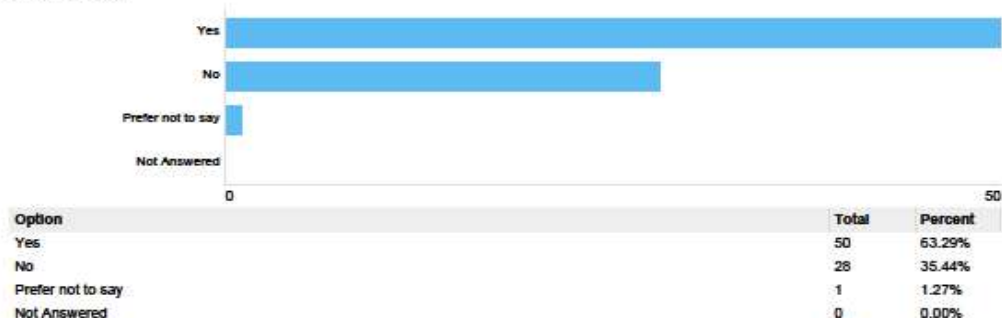

Do you have any comments further to your answer?

There were 62 responses to this part of the question.

Question 2: Do you support proposals to upgrade bus stop facilities on Polegate High Street?

Bus stop proposals



Option	Total	Percent
Yes	63	79.75%
No	14	17.72%
Prefer not to say	2	2.53%
Not Answered	0	0.00%

Do you have any comments further to your answer?

There were 38 responses to this part of the question.

Question 3: Do you support the proposals for the pedestrian areas on Polegate High Street?

Do you support pedestrian areas



Option	Total	Percent
Yes	63	79.75%
No	15	18.99%
Prefer not to say	0	0.00%
Not Answered	1	1.27%

Do you have any comments further to your answer?

There were 36 responses to this part of the question.

Note:- a full printout of the consultation comments received through Citizen Space is available if required. These have not been reproduced here due to space limitations (approximately 88 x A3 pages printed full size).

Summarising the results:-

50 responses were in support of the proposals

28 responses were against the proposals

1 responder preferred not to say.

Appendix E – Email Response Summary

Note:- a full printout of the consultation comments received by email is available if required. These have not been reproduced here due to space limitations (approximately 35 x A4 pages printed full size).

Summarising the results:-

9 responses were in support of the proposals.

5 responses were against the proposals.

11 responders did not express a preference.