

# EB/812/CM

Variation of Conditions 5 & 6 to extend the operational hours.

Eastbourne Household Waste Recycling Site, St Philip's Avenue, Eastbourne.

EB/812/CM  
Eastbourne Household Waste Recycling Site, St Philip's Avenue, Eastbourne.

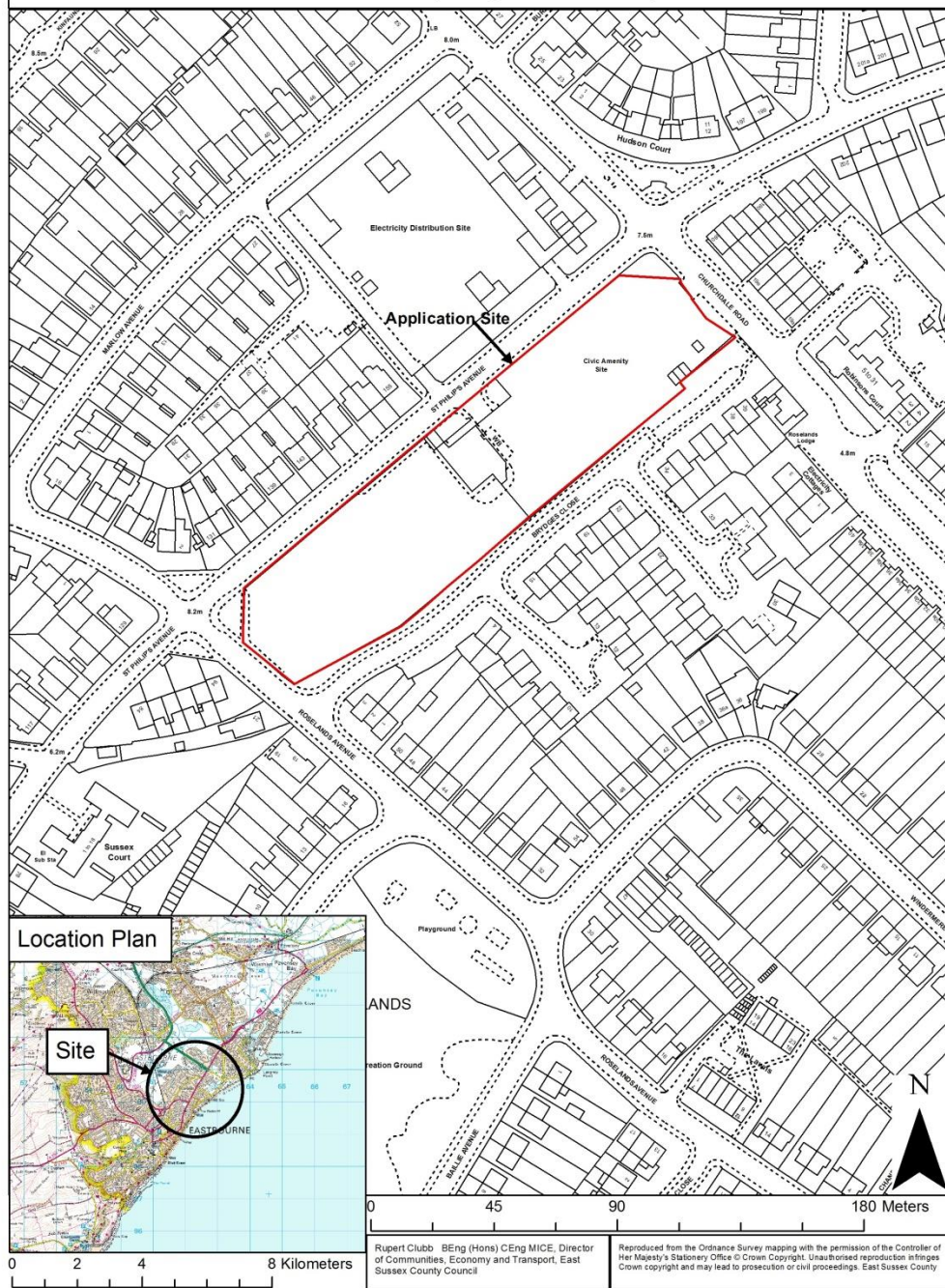



EB/812/CM  
Eastbourne Household Waste Recycling Site, St Philip's Avenue, Eastbourne.





# Eastbourne HWRC/Roselands Depot, St Philip's Avenue BN22 8NB



Ordnance Survey © Crown Copyright 2018. All rights reserved. Licence number 100022432. Plotted Scale - 1:1250







Looking south-east across the HWRS from St Philip's Avenue





View east along St Philip's Avenue with electricity sub-station on left side

























# EB/812/CM

Variation of Conditions 5 & 6 to extend the operational hours.

Eastbourne Household Waste Recycling Site, St Philip's Avenue, Eastbourne.