

**Appendix 1:**

**Location Plan**



Church Lane/Church Road  
Junction.  
Parking Restrictions implemented  
in February 2019

Catsfield Church of  
England Primary school

St. Laurence's  
Church

B2204

Proposed 30 mph  
speed limit extension

Church Road

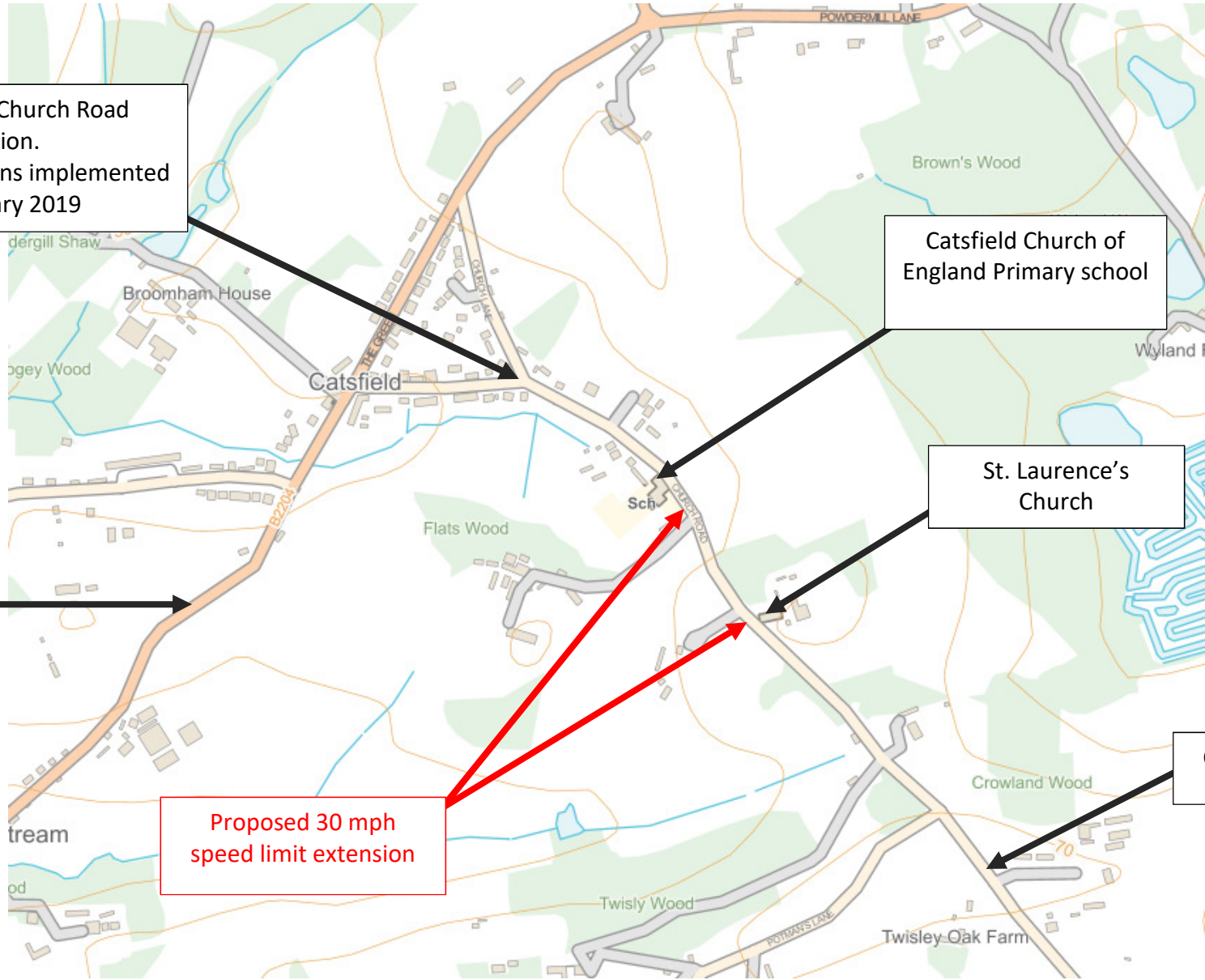

**Appendix 2:**

**Draft Notice**

EAST SUSSEX COUNTY COUNCIL

ROAD TRAFFIC REGULATION ACT 1984

**The East Sussex (C345 Church Road, Catsfield)  
(30 mph Speed Limit) Order 201\***

**Notice** is hereby given that East Sussex County Council propose to make an Order under Section 84 (1) and (2) of the Road Traffic Regulation Act 1984, as amended, and of all other enabling powers, which will extend the 30 mph speed limit on the following length of road:-

**30 mph Speed Limit**

**Church Road** from a point 38 metres east of the eastern wall of Catsfield Church of England primary school, south eastwards for a distance of 270 metres.

A copy of the draft Order, plans showing the lengths of road and a statement of the Council's reasons for proposing the Order, along with those parts of Orders being revoked and consolidated into this Order, may be examined in Reception, East Sussex County Council, County Hall, St Anne's Crescent, Lewes BN7 1UE on Monday to Friday 9am - 4pm and at Battle Library, 7 Market Square, Battle TN33 0XB on Tuesday 10am - 4pm, Wednesday 10am – 1pm, Thursday 11am – 6pm, Friday and Saturday 10am – 5pm.

Any person wishing to make an objection or other representation concerning this proposal must do so in writing, together with the grounds on which it is made, to Communities Economy & Transport, Parking, B Floor, East Sussex County Council, County Hall, St. Anne's Crescent, Lewes BN7 1UE or email [TROs@eastsussex.gov.uk](mailto:TROs@eastsussex.gov.uk) quoting reference TRO/435 by 31 May 2019.

For further information, telephone Infrastructure & Transportation, East Sussex Highways on 0345 60 80 193.

**Philip Baker, Assistant Chief Executive,  
Governance Services Department, County Hall, Lewes, East Sussex BN7 1UE**

10 May 2019

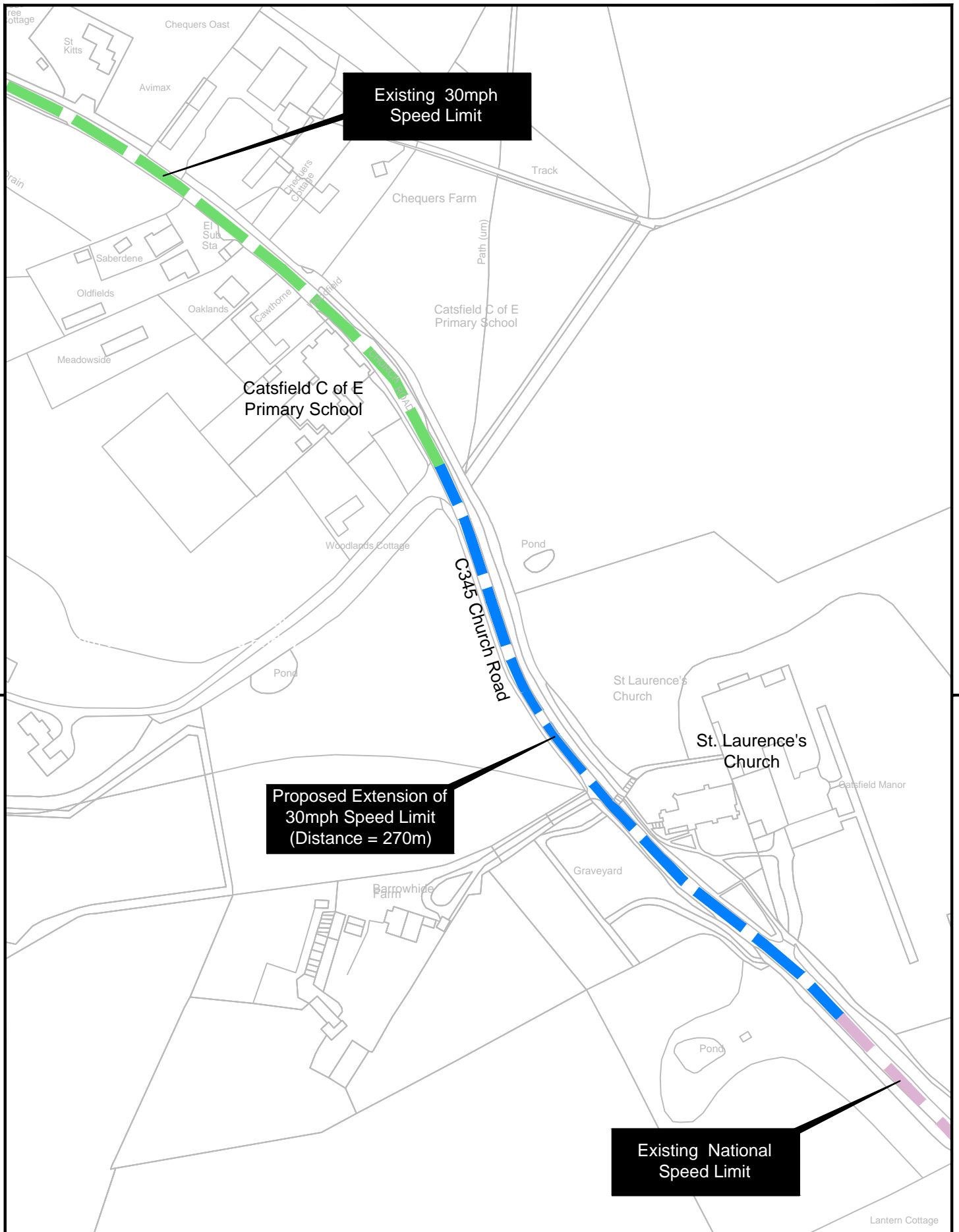

Existing 30mph  
Speed Limit

Proposed Extension of  
30mph Speed Limit  
(Distance = 270m)

Existing National  
Speed Limit



East Sussex  
County Council

East Sussex Highways



C345 CHURCH ROAD,  
CATSFIELD

SCALE	1:2000
DATE	12 February 2019
DRAWING No.	LSI-SCH0090-DR-CH-001
DRAWN BY	CK
SHEET 1 OF 1	© Crown copyright. All rights reserved East Sussex County Council Licence No. 100019601 2015.

## **Appendix 3:**

### **Improvement measures in support of 30mph speed limit extension**



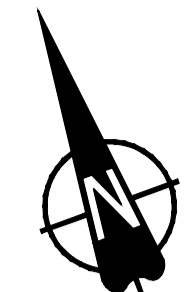
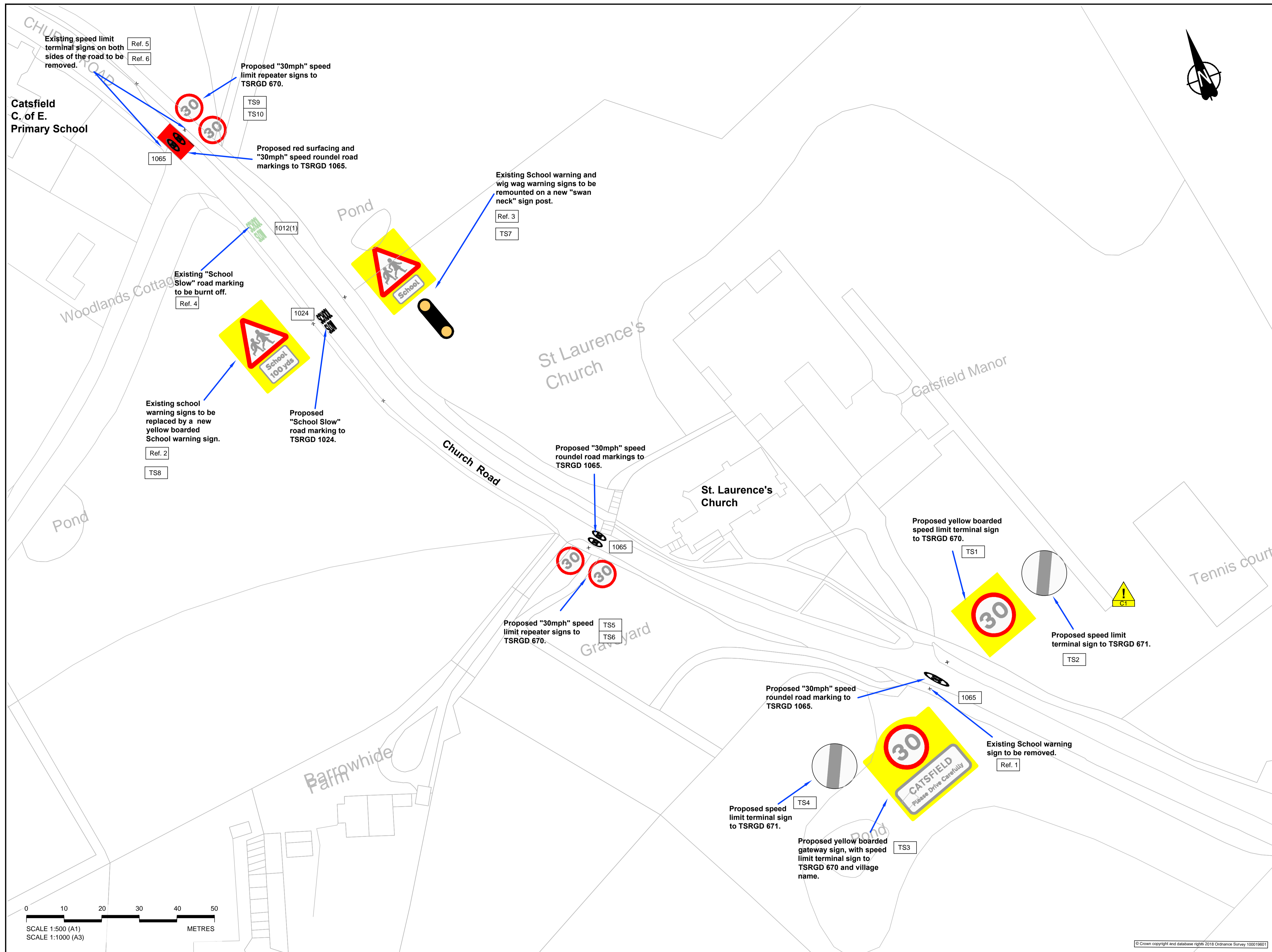

- KEY Traffic signs, Road Markings & Street Furniture
- TS1 Proposed non-illuminated traffic sign. See Appendix 12/1 for details
  - 1004(1) Proposed road marking [with TSRGD 2016 Ref.].
  - Site Clearance
  - Ref. 1 Item of existing street furniture to be cleared. See Appendix 12/1 for details

**SAFETY HEALTH AND ENVIRONMENTAL INFORMATION**

In addition to the hazards and risks normally associated with the type of works detailed on this drawing, note the following significant hazards/risks and information. For additional information refer to the project's Pre-Construction Information.

REF.	DESCRIPTION
<b>CONSTRUCTION H&amp;S HAZARDS/ RISKS</b>	
C1	Overhead Cable
<b>ENVIRONMENTAL HAZARDS/ RISKS</b>	
E1	

The design team have only highlighted the reasonably foreseeable significant hazards/risks that may not be obvious to an experienced competent contractor, are unusual, and/or may be difficult to manage. The information provided is to assist with risk reduction and control and is not necessarily comprehensive. It is assumed that all construction works are to be carried out in accordance with adequately developed method statements that have been prepared and approved by an experienced competent contractor. Should any additional significant hazards/risks be identified by the Contractor during the course of the works then the Contractor shall immediately advise the appropriate relevant members of the design team and where appropriate the Principal Designer.

For H&S information relating to post construction completion cleaning, maintenance, refurbishment and dismantling/demolition refer to the project's Health and Safety File.

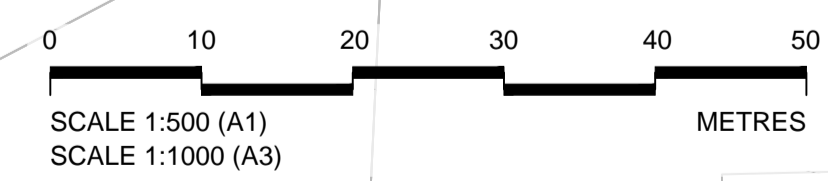

© Crown copyright and database right 2018 Ordnance Survey 100019801

Rev	Status	Rev. Date	Purpose of revision	Drawn	Chk'd	Apprv'd
P03	S2	15/07/2019	Change of Gateway Sign	CK	IT	JV
P02	S0	29/08/2018	Edge of carriageway road marking removed	CK	IT	JV
P01	S0	12/07/2018	Preliminary/Detail design	CK	IT	JV

Project	Status	Revision
Catsfield School	S2	P03
Scale	1 : 500 in A1	Date 12/07/2018
Drawn By	Christine Kwok	
Checked By	Ian Tingley	
Approved By	James Vaks	
Project No.	3520000	1 Originator ESH Original Size A1
Drawing number	Volume 1 Design Alt. 1 Type 1 Role 1 Number HGN-SCH0090-DR-CH-0007	

**East Sussex Highways**  
 A partnership between:  
 COSTAIN CH2M

EAST SUSSEX HIGHWAYS  
 RINGMER DEPOT, THE BROYLE  
 RINGMER, EAST SUSSEX, BN8 5NP  
 Tel. 0345 60 80 193 www.eastsussexhighways.com

Project	Drawing title
Catsfield School	Proposed 30mph Speed limit extension Signing and Lining