

Committee:	<b>Regulatory Planning Committee</b>
Date:	<b>11 November 2019</b>
Report by:	<b>Director of Communities, Economy and Transport</b>
Title of Report	<b>Traffic Regulation Orders – Friends Meeting House Car Park, Styles Field, Lewes</b>
Purpose of Report	<b>To consider the objection received in response to the formal consultation on the draft Traffic Regulation Order associated with the Friends Meeting House Car Park proposal</b>
Contact Officer:	<b>Daniel Clarke -Tel. 01323 464057</b>
Local Members:	<b>Councillor Ruth O’Keeffe</b>

---

## **RECOMMENDATION**

**The Planning Committee is recommended to:**

- 1. Not uphold the objection to the draft Order as set out in Appendix 1 of this report.**
  - 2. Recommend to the Director of Communities, Economy and Transport that the Traffic Regulation Order be made as advertised.**
- 

## **CONSIDERATION BY DIRECTOR OF COMMUNITIES, ECONOMY AND TRANSPORT.**

### **1. Introduction**

- 1.1** In July 2018 East Sussex County Council’s Parking team entered into a partnership with the Library Service, which would see the parking enforcement contractor (NSL Services) move from their various offices to the libraries in Eastbourne, Hastings, and Lewes. The partnership allows NSL to have use of back office space as well as welfare facilities for office staff and Civil Enforcement Officers (CEOs).
- 1.2** The Partnership was introduced to make better use of our libraries as visits by customers and loans of items have decreased significantly over the past ten years. By offering both parking and library services in one place we are able to make best use of our resources, and providing parking services in libraries enables parking customers to access library services during their visit. Similarly, library customers also benefit from easy access to our parking services.
- 1.3** Whilst planning for the new partnership a request was received from Friends Meeting House in Lewes to formalise and enforce the parking bays on their land. In return it was agreed that two bays would be introduced for the NSL patrol vehicles and one disabled parking bay for library customers, initially for the life of the NSL contract.
- 1.4** The formal proposals were advertised, together with the draft Traffic Regulation Order (TRO) (a copy of which is attached at Appendix 2) in the Sussex Express on 12 July 2019. Notices and copies of the relevant plans were placed on posts and lamp-columns in the car park and the consultation was placed on the Council’s Consultation Hub for any member of the public to comment. The formal period for representations to be made ended on 2 August 2019.

- 1.5 Copies of the formal proposals were sent to relevant District and Town Councillors, County Councillors and statutory consultees including the emergency services. Copies of all supporting correspondence are available in the Members' Room.
- 1.6 During the formal consultation the one item of correspondence received was an objection to NSL having two bays for their patrol vehicles.

## **2. Comments and Appraisal**

- 2.1 The objection has been considered and a summary of the objection and officer comments are included in Appendix 1. Plans and photographs showing the area objected to are included in the Additional Information Pack.

## **3. Conclusion and reasons for recommendation**

- 3.1 The approach in trying to resolve the objection to the Order has been to appraise the concerns raised by the objector, whilst not compromising other factors. It is felt for NSL's operational efficiency and the welfare and health and safety of CEOs, that the objection should not be upheld and the proposals should proceed as per the draft TRO as advertised.
- 3.2 It is therefore recommended for the reasons set out in this report, that the Planning Committee does not uphold the objection in Appendix 1, and recommends to the Director of Communities, Economy, and Transport that the Order be made as advertised.

RUPERT CLUBB  
Director of Communities, Economy and Transport

## **BACKGROUND DOCUMENTS**

**Appendix 1 – Proposals where objections are recommended to not be upheld and are proposed to be implemented as advertised**

**1. Site 1 Friends Meeting House Car Park, Lewes**

- 1.1 A request was made by Friends Meeting House to introduce seven off street permit holder parking bays, one permit holder disabled bay and one general use disabled bay. This request was made as users of Friend's Meeting House have found they are unable to use their car park due to an increase in vehicles parking that are not using their facilities. This can result in their members needing to find alternative parking.
- 1.2 The agreement with Friends Meeting House included one disabled parking bay for use by Library customers (limited to three hours maximum stay), and two bays for the use of NSL's patrol vehicles.
- 1.3 One objection has been received. The grounds for the objection are that it was unfair that NSL would get dedicated permit bays. The objector says that the enforcement team should be using public transport to get to work and not take precious spaces from residents. The objector also said that NSL should be using electric vehicles and that there were no electric vehicle charging points in the Friends Meeting House Car Park.
- 1.4 Having considered the objection, officers are satisfied that there are not sufficient grounds for the proposal to be withdrawn. The two bays will not be used as private parking spaces by staff, they will be for the use of NSL patrol vehicles for operational reasons and the hybrid vehicles are essential to the delivery of the service. The bays will also help ensure the welfare and health and safety of CEOs is not compromised.
- 1.5 Without the dedicated spaces it would be necessary to park the patrol vehicles in nearby streets, increasing demand on limited available kerb space.
- 1.6 ESCC and NSL are looking into the feasibility of switching to fully electric vehicles. However, it is not considered necessary or appropriate to either delay or not implement the parking proposal pending the outcome of these considerations.
- 1.7 **Recommendation:** To not uphold the objection and install the proposals as advertised.

**Appendix 2 – Proposed Traffic Regulation Order (TRO)**

**EAST SUSSEX COUNTY COUNCIL**

**ROAD TRAFFIC REGULATION ACT 1984**

---

**The East Sussex County Council (Lewes District) (Off-Street Parking Places)  
Traffic Regulation Order 2013 (Amendment No.\*) (Friend's Meeting House) Order 201\***

---

East Sussex County Council, in collaboration with Lewes District Council, in exercise of their powers under sections 32, 35, 39(6) and Part IV of Schedule 9 of the Road Traffic Regulation Act 1984 (hereinafter referred to as "the Act of 1984"), as amended by the Parking Act 1989 and the Road Traffic Regulation Act 1991, Traffic Management Act 2004 and of all other enabling powers and after consultation with the Chief Officer of Police in accordance with Part III of Schedule 9 of the Act of 1984, hereby makes the following Order:

1. When this Order comes into effect The East Sussex County Council (Lewes District) (Off-Street Parking Places) Traffic Regulation Order 2013 as amended, shall have effect except as hereinafter contained.
2. In Schedule 1 introduce the following amendment: -

1	2	2.5	3	4	5	6	7	8	9	10	11	12	13
Town or Village	Name	Maximum Height	Vehicle Type	Type of Bay	User Type	Days of Use	Times of Use	Days of Charging	Times of Charging	Charging Band	Maximum length of stay (hours)	Minimum length of time between stays (hours)	Drawing ref
Lewes	Friends Meeting House Car Park		Motor	Disabled	Vehicles displaying a valid blue badge	Mon - Sat	8am – 6pm	None	None	None	2	2	CP58
				Specific user bay	Vehicles displaying a valid permit for the bays as shown on the tariff sign	All days	All times	None	None	None	None	None	
					Vehicles displaying a valid permit for the bays as shown on the signs	All days	8am – 8pm	None	None	None	None	None	
					Vehicles displaying a valid permit for the bays and a valid blue badge as shown on the signs	All days	8am – 8pm	None	None	None	None	None	

6. In Schedule 4 insert Plan Reference CP58 for Friends Meeting House

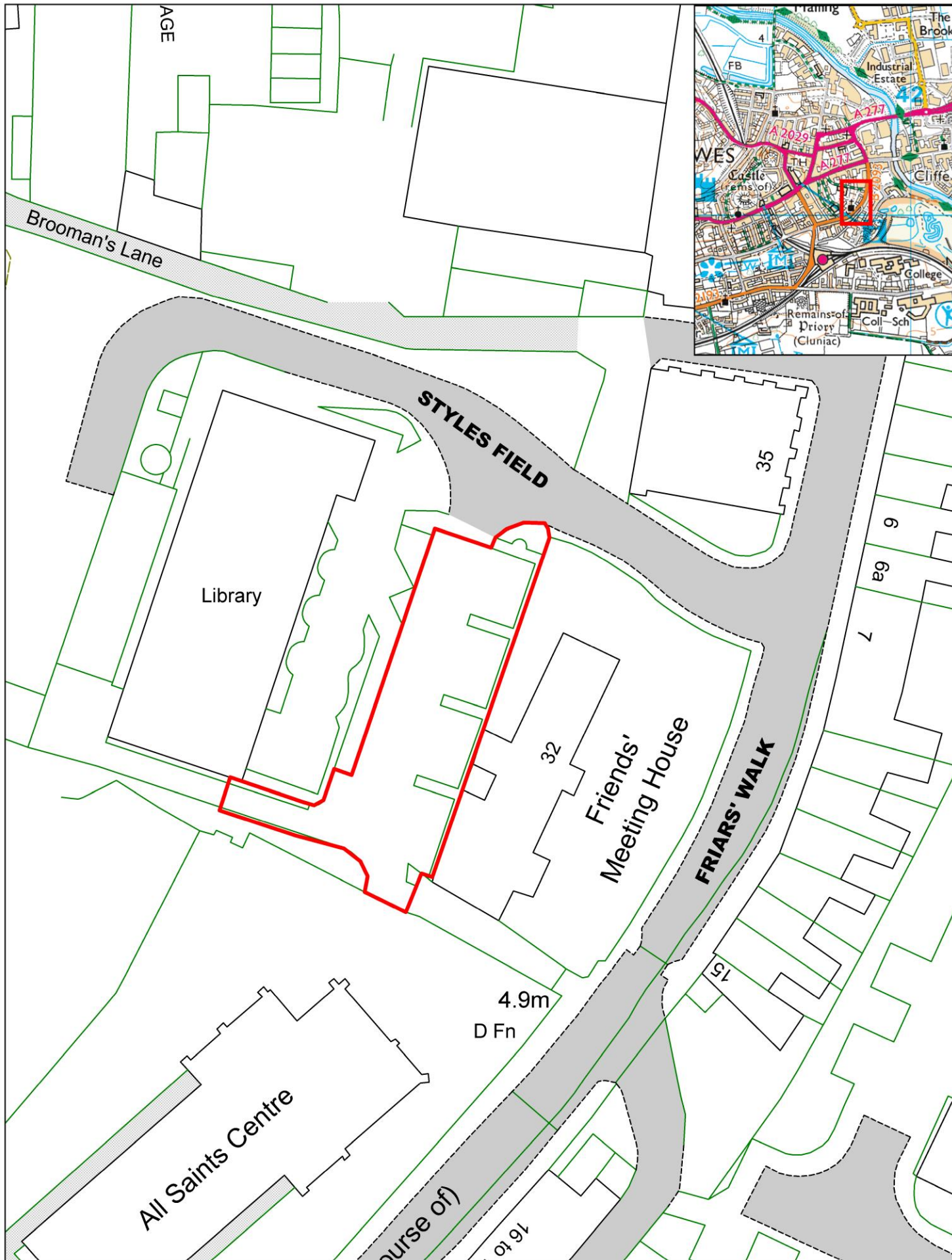

# Friends Meeting House Car Park

## Lewes



SCALE	1:500
DATE	05/07/2018
MAP REF	CP58

## 1. Citation

This Order may be cited as “The East Sussex County Council (Lewes District) (Off-Street Parking Places) Traffic Regulation Order 2013 (Amendment No.\*) Order 201\* and shall come into operation on \*\*\*\*\*

THE COMMON SEAL of EAST SUSSEX)  
COUNTY COUNCIL was affixed )  
hereto on the day of two )  
thousand and in the presence of:- )

Authorised Signatory

H & T Ctte. 2.4.74 - para 4.2 joint report of Director of Legal &  
Community Services & County Engineer - para 4