

East Sussex County Council Planning Committee 13 March 2024

Traffic Regulation Order – Harrow Lane, St Leonard's on Sea

Proposed No Waiting at Any Time Restrictions
(Double Yellow Lines)

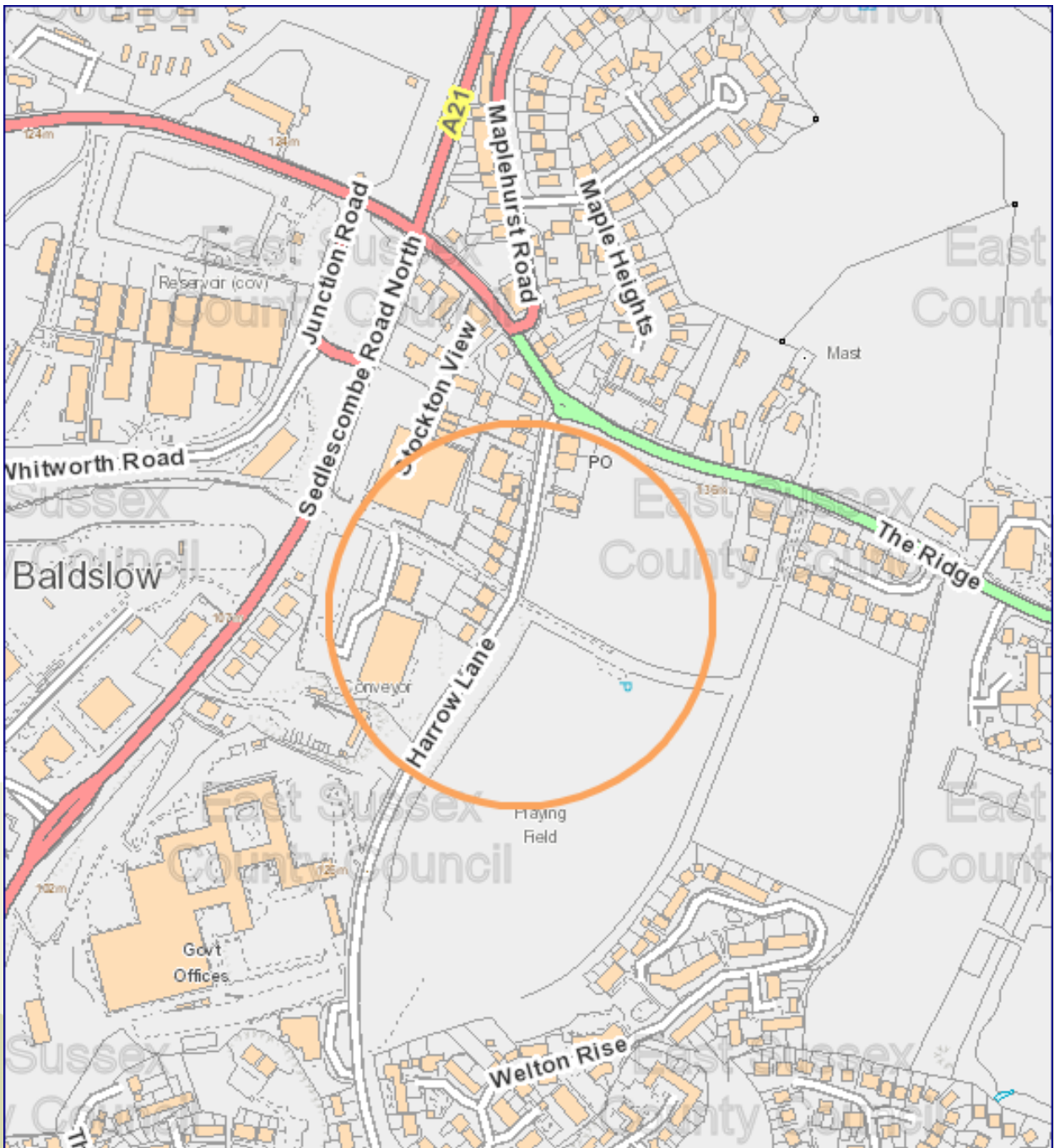

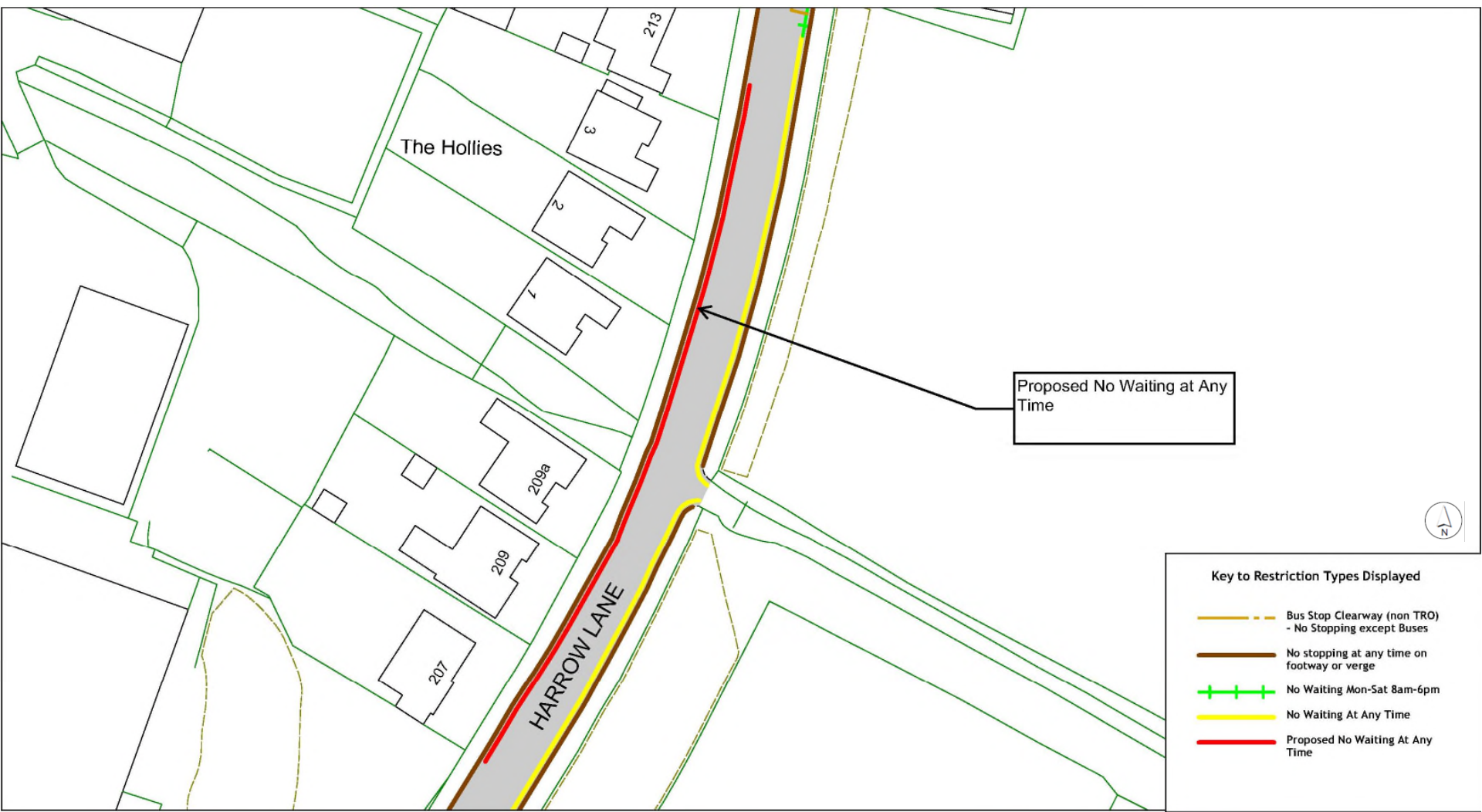



View 2, Harrow Lane looking South with the new development to the west of the image



View 3, The Double Yellow Lines will be put along the right side of the attached photo. 7
This imagine has been taken from the central reservation looking south



View 4, The new developments are located to the east of this image, which has been taken from the central reservation looking north on Harrow Lane



Traffic Regulation Order – Harrow Lane, St Leonard's on Sea

Proposed No Waiting at Any Time Restrictions
(Double Yellow Lines)

East Sussex County Council Planning Committee 13 March 2024